

# Glen More Organizer

Compatible with Glen More II®

This box organizer is compatible with Glen More II®  
This product is licensed, and is up for change at any time in the future.



## Assembly Guide

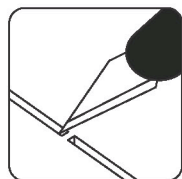

Use an exacto knife to cut the bits connecting the parts to the frame.

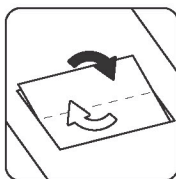

Remove the parts from the frame with a rotating motion along the axis formed by the bits you just cut.

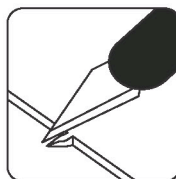

Use the exacto knife to remove any of the remaining connection bits.

Use **wood glue** for assembly. Always dry fit the parts first to make sure the components are correct ones. If you encounter any issues, please contact us at [info@laserox.net](mailto:info@laserox.net) or our Facebook page at [facebook.com/laseroxinserts](https://facebook.com/laseroxinserts).

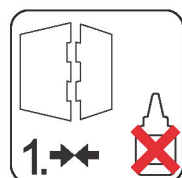

Always dry-fit the parts to together without any glue to make sure you are assembling the correct parts.



Use a drop of glue along the joints and hold it in place until the glue has sufficiently dried.

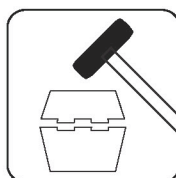

Press the parts together or use a hobby hammer with slight force for assembly.



**WARNING** Choking hazard!  
Not for children under 3 years.

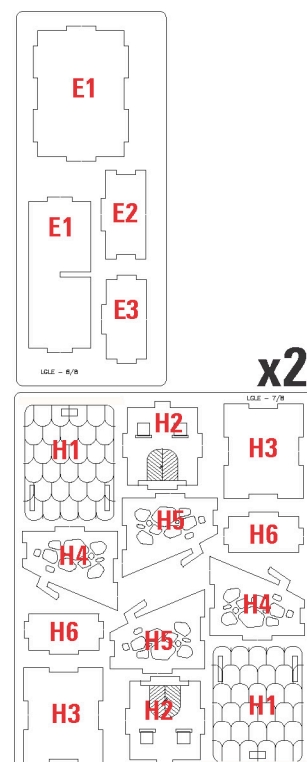
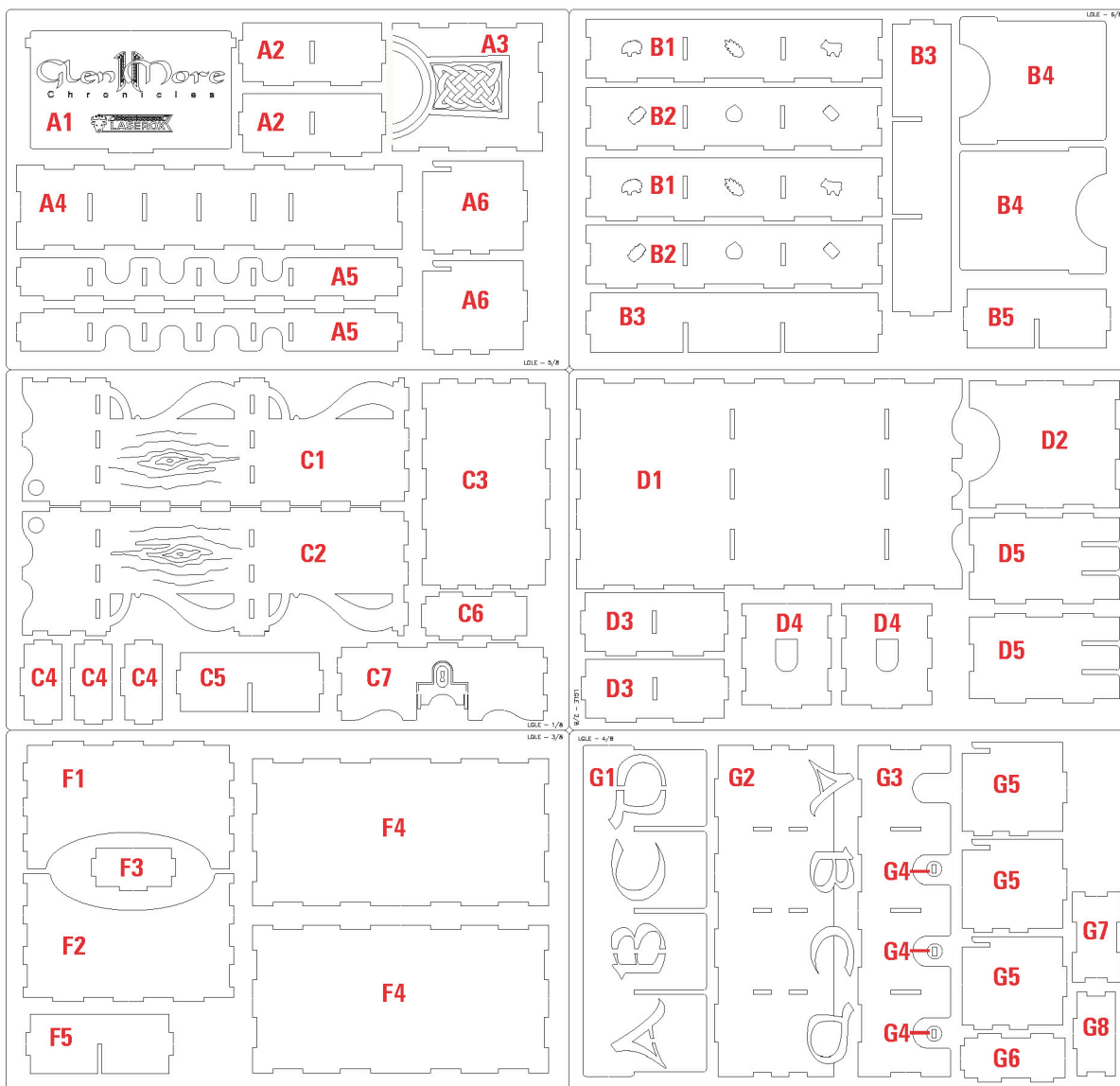

1

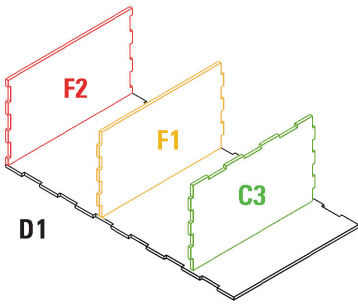

2

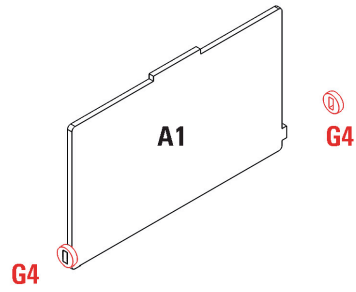

3

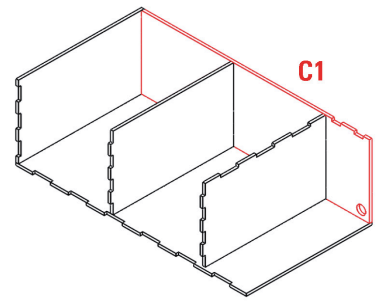

4

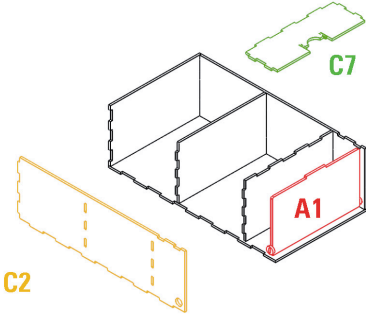

5

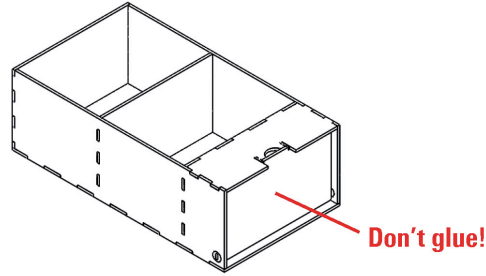

Required parts: A1, C1, C2, C3, C7, D1, F1, F2, G4x2,

1

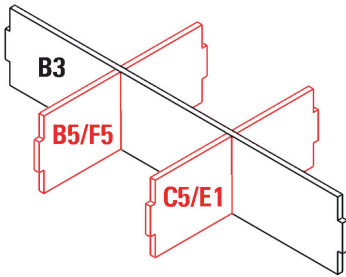

2

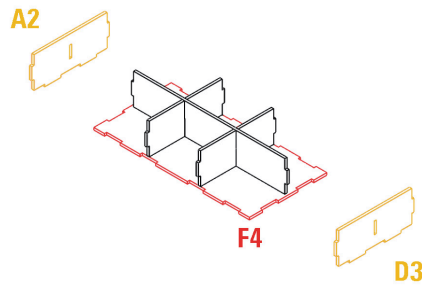

3

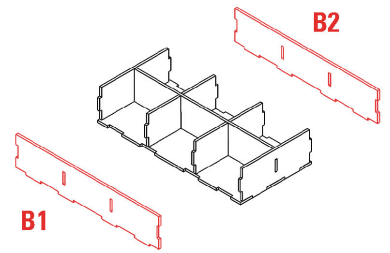

4

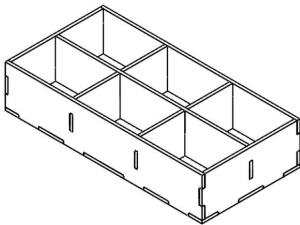

x2

Required parts: A2, B1, B2, B3, B5/F5, C5/E1, D3, F3,

1

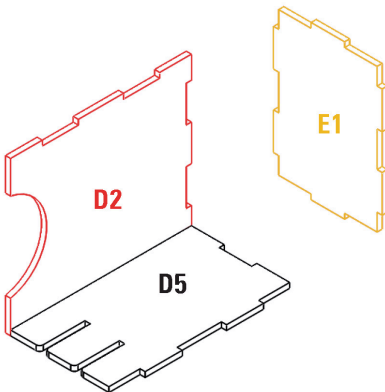

2

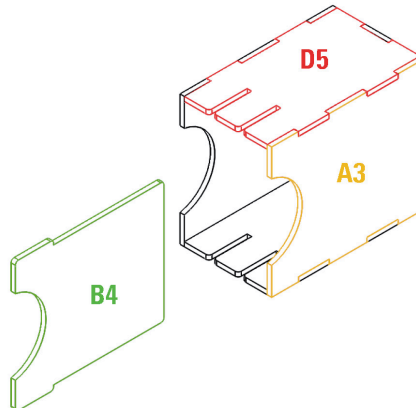

3

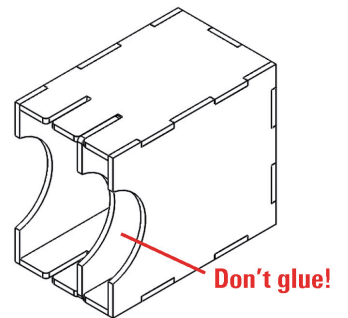

Required parts: A3, B4x2, D2, D5, E1,



1

## Player Houses

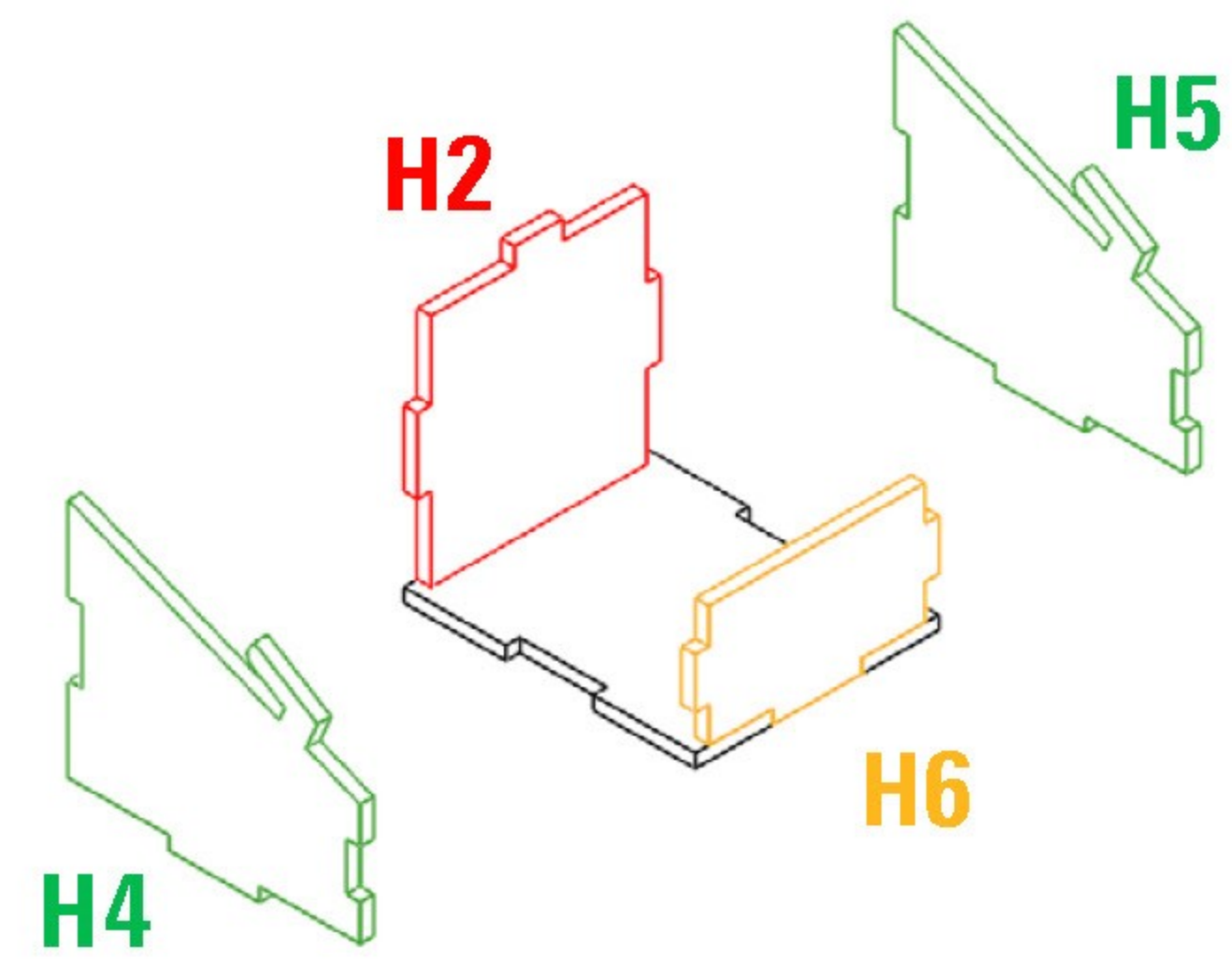

Required parts: **H1, H2, H3, H4, H5, H6,**

2



## Coin Tray

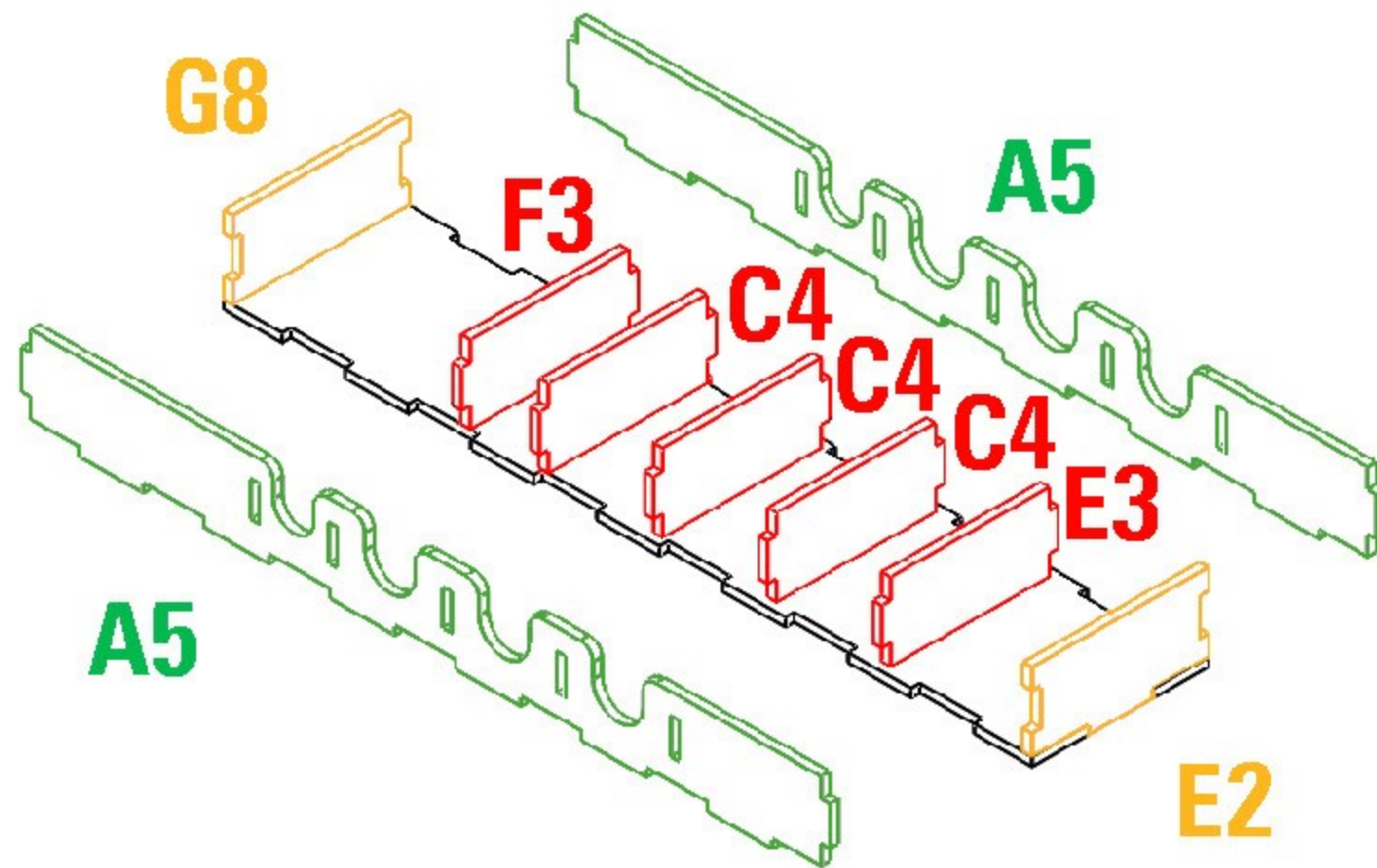

Required parts: **A4, A5x2, C4x3, E2, E3, F3, G8,**

2

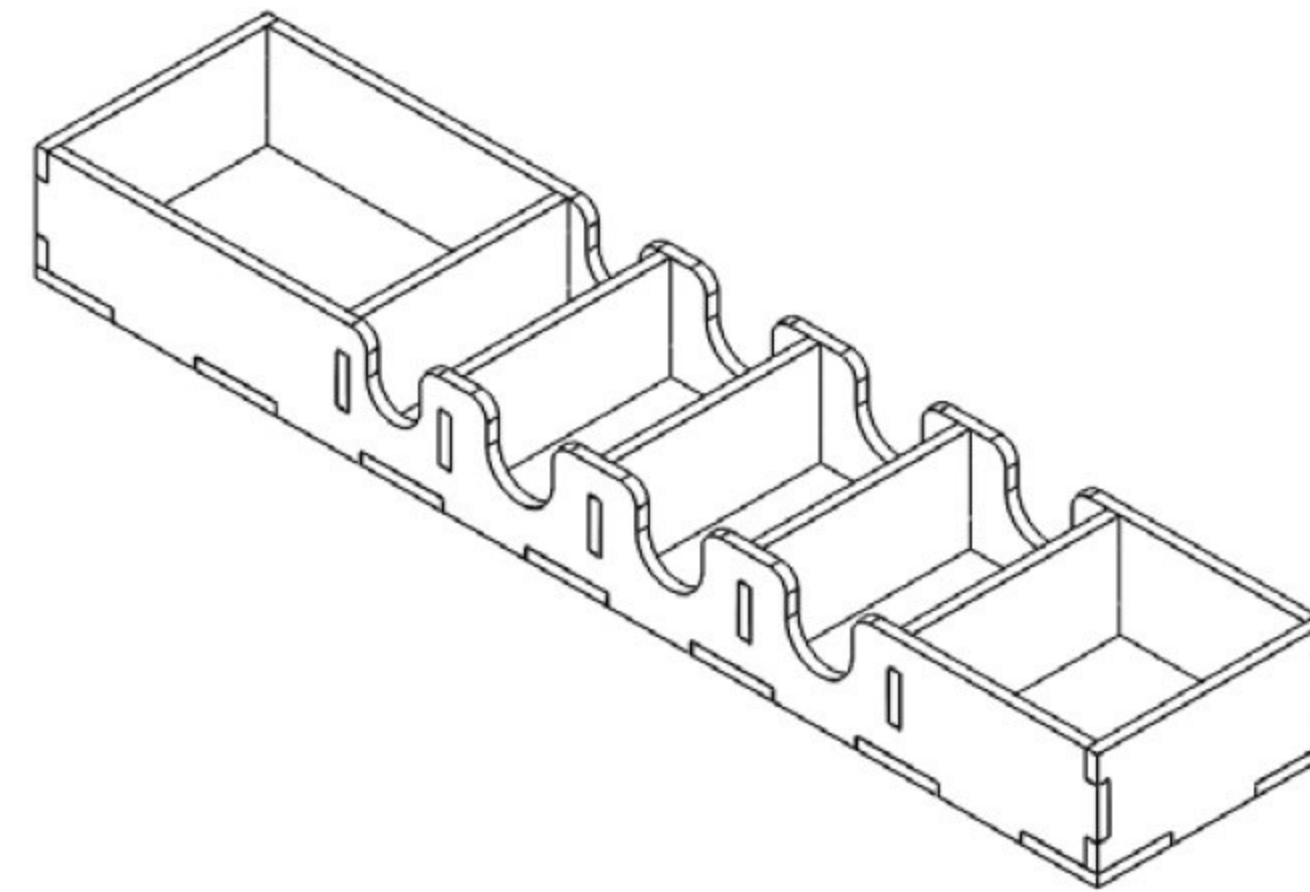

## Tile Storage

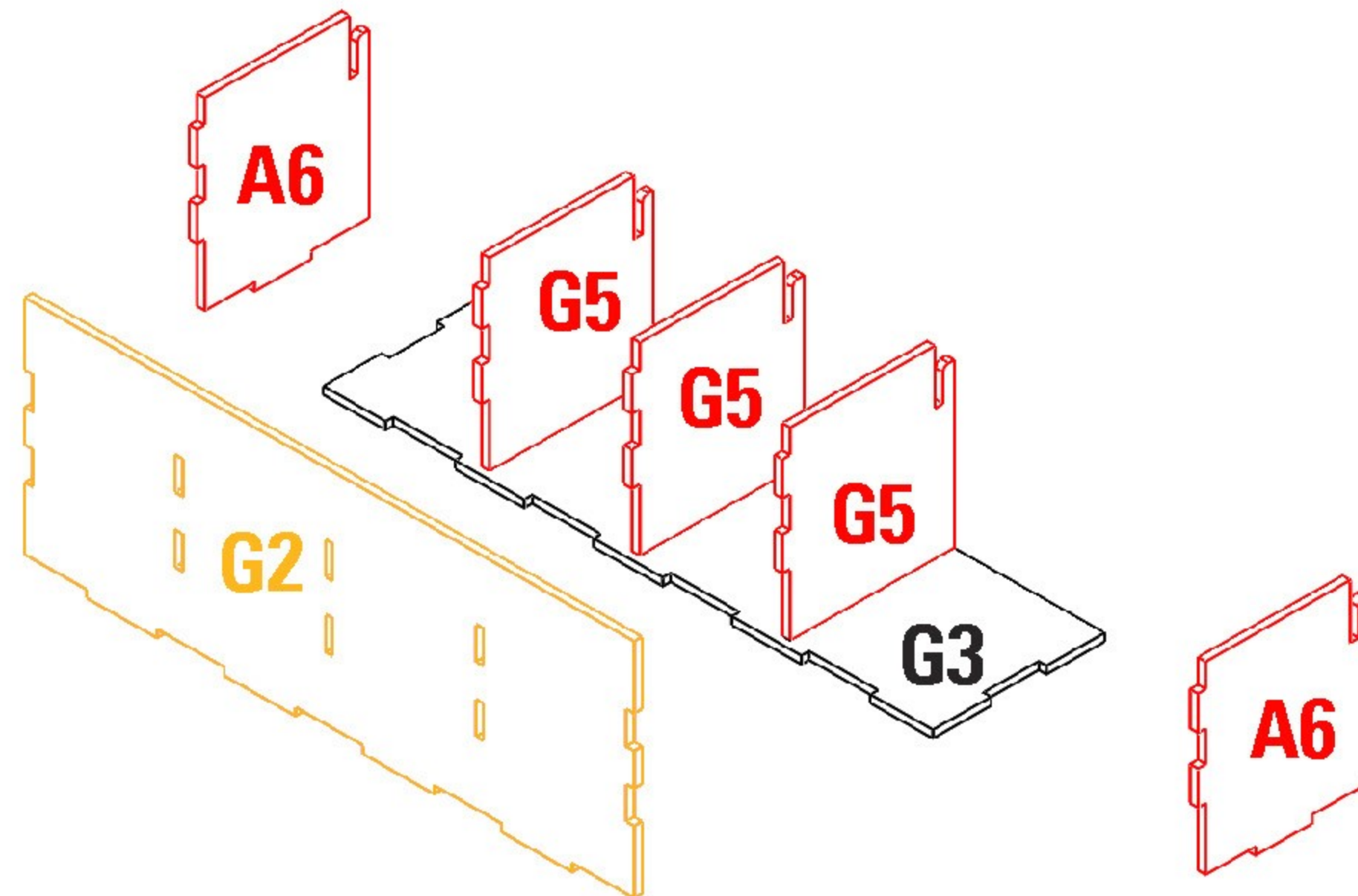

Required parts: **A6x2 G1, G2, G3, G5x3,**

2

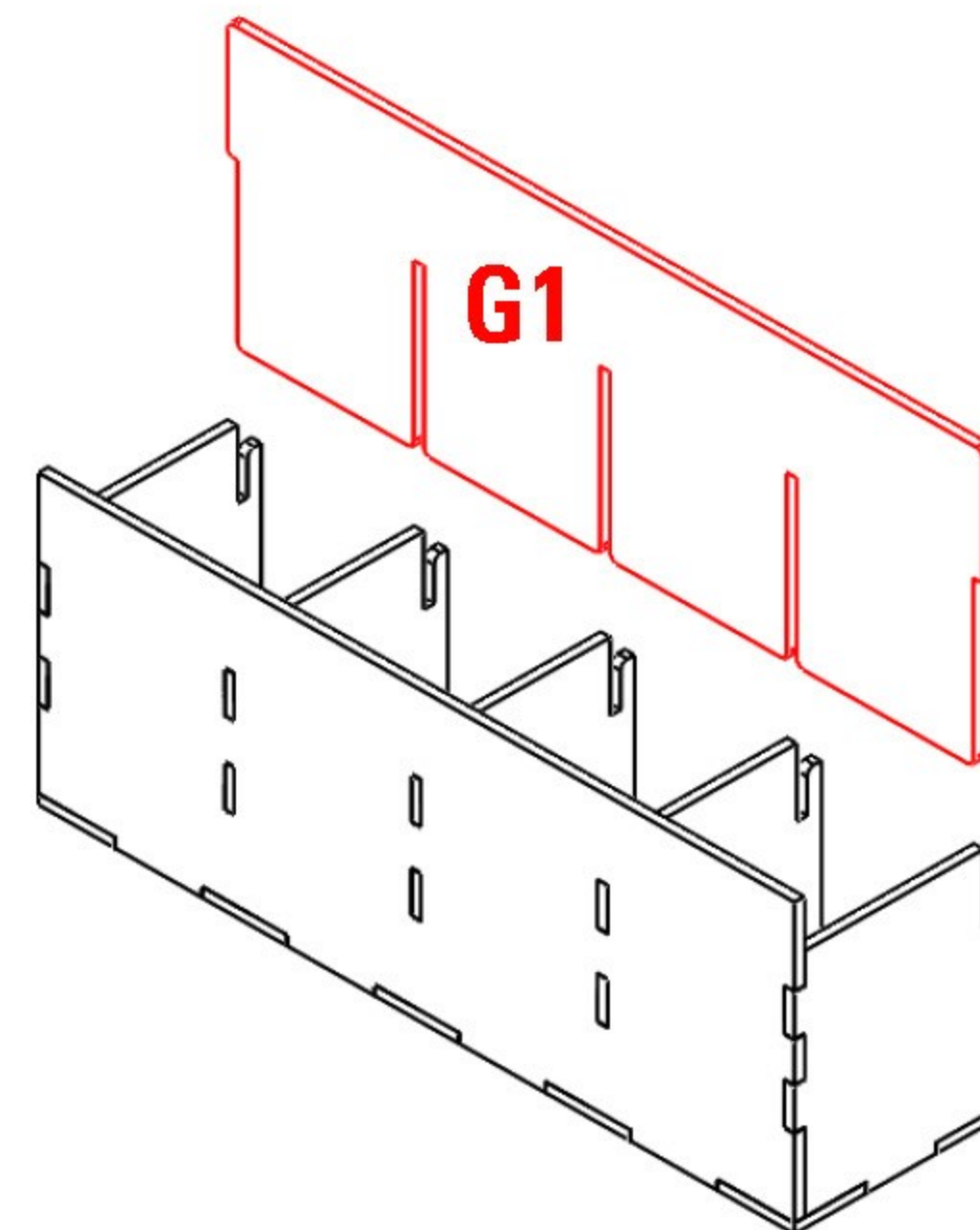

3

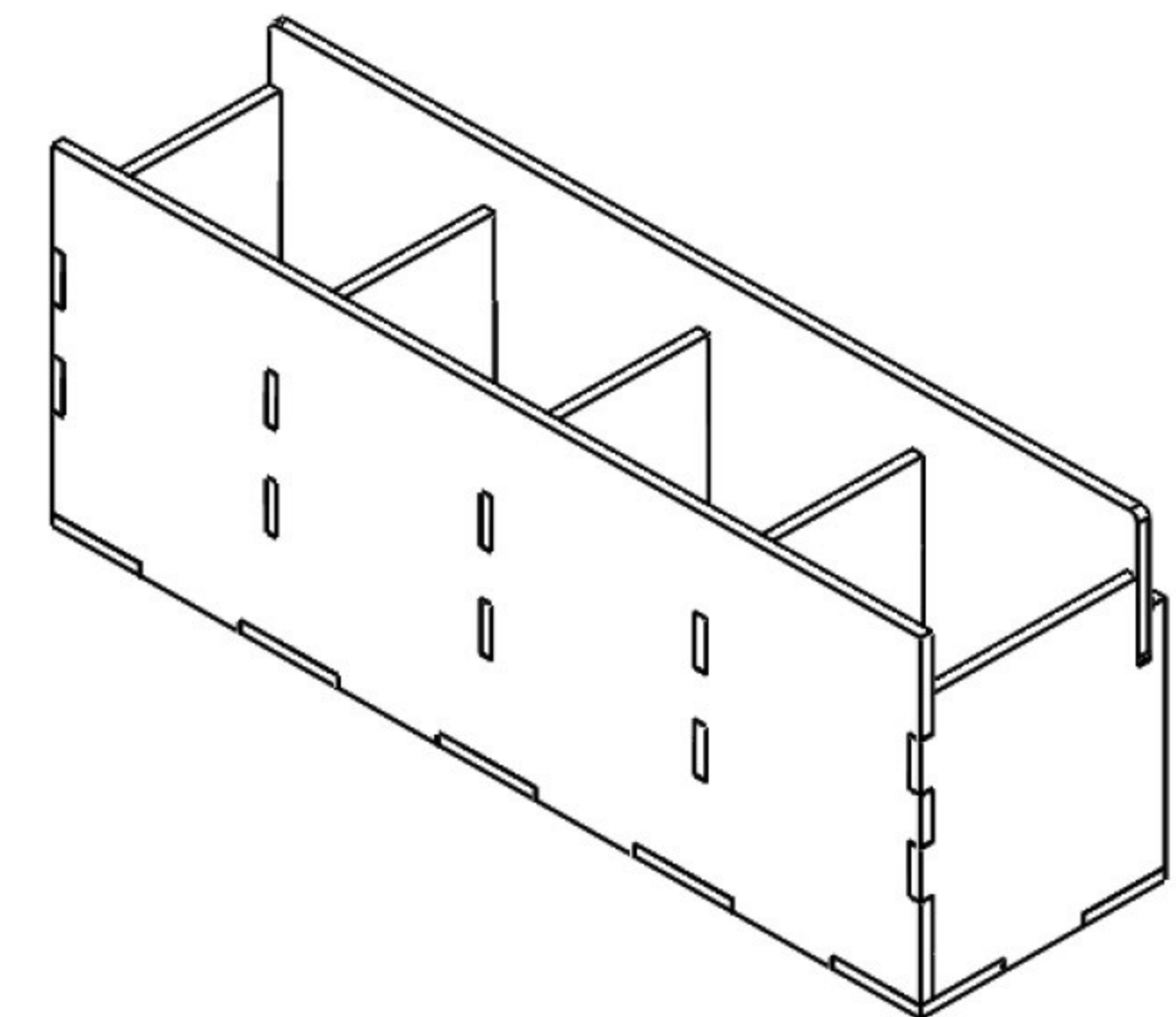



1

Shield Tray

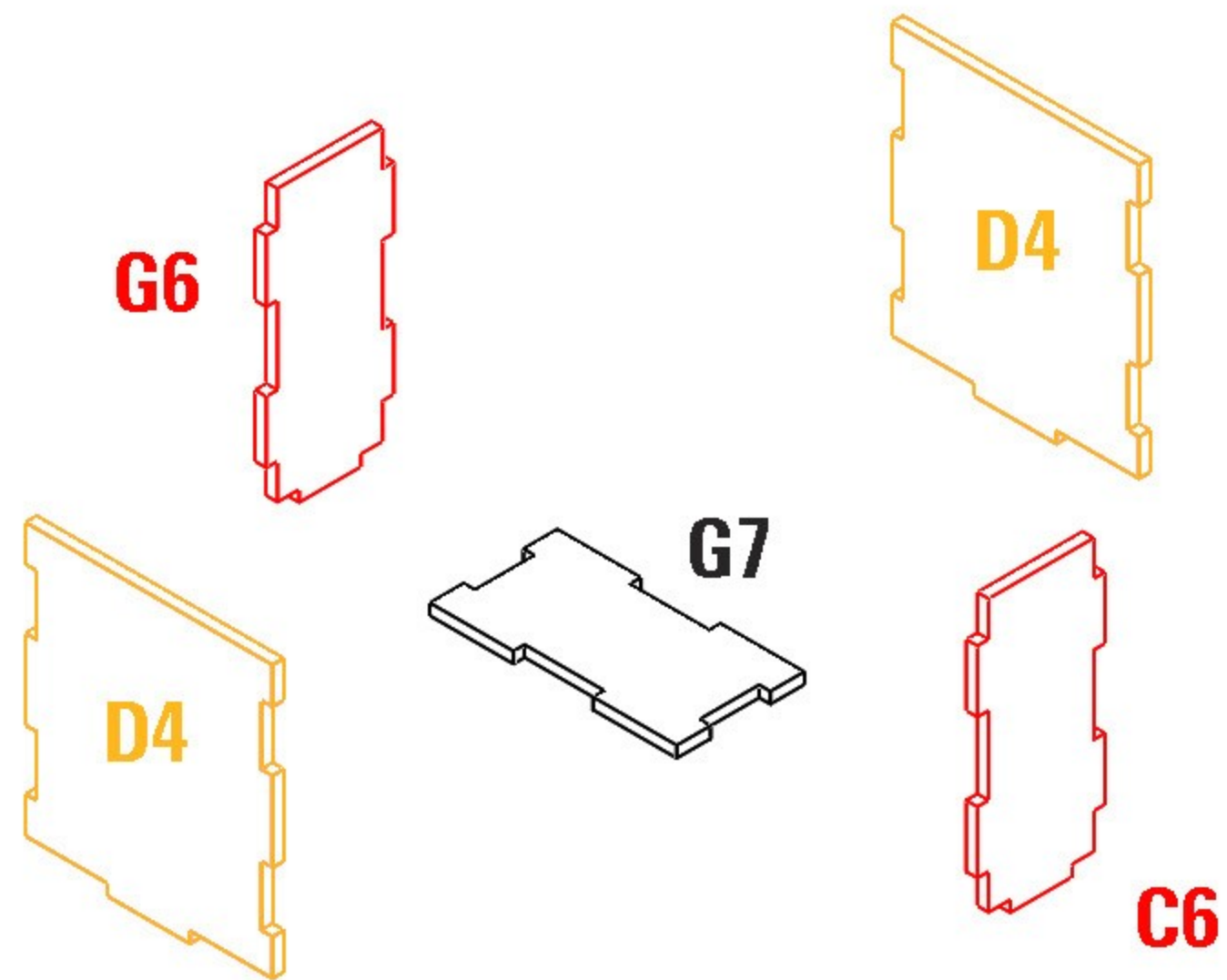

2

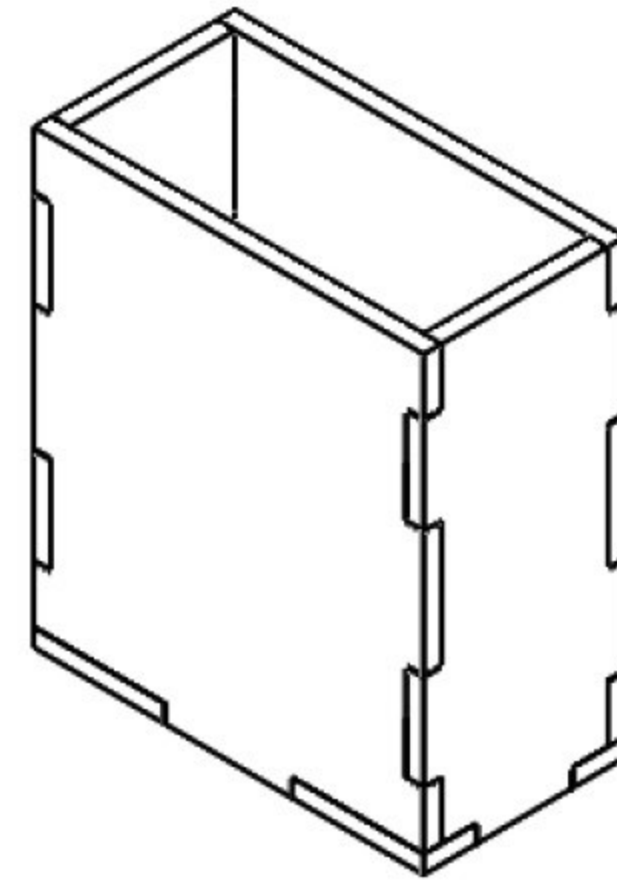

Required parts: **C6**, **D4x2**, **G6**, **G7**,

Assembly

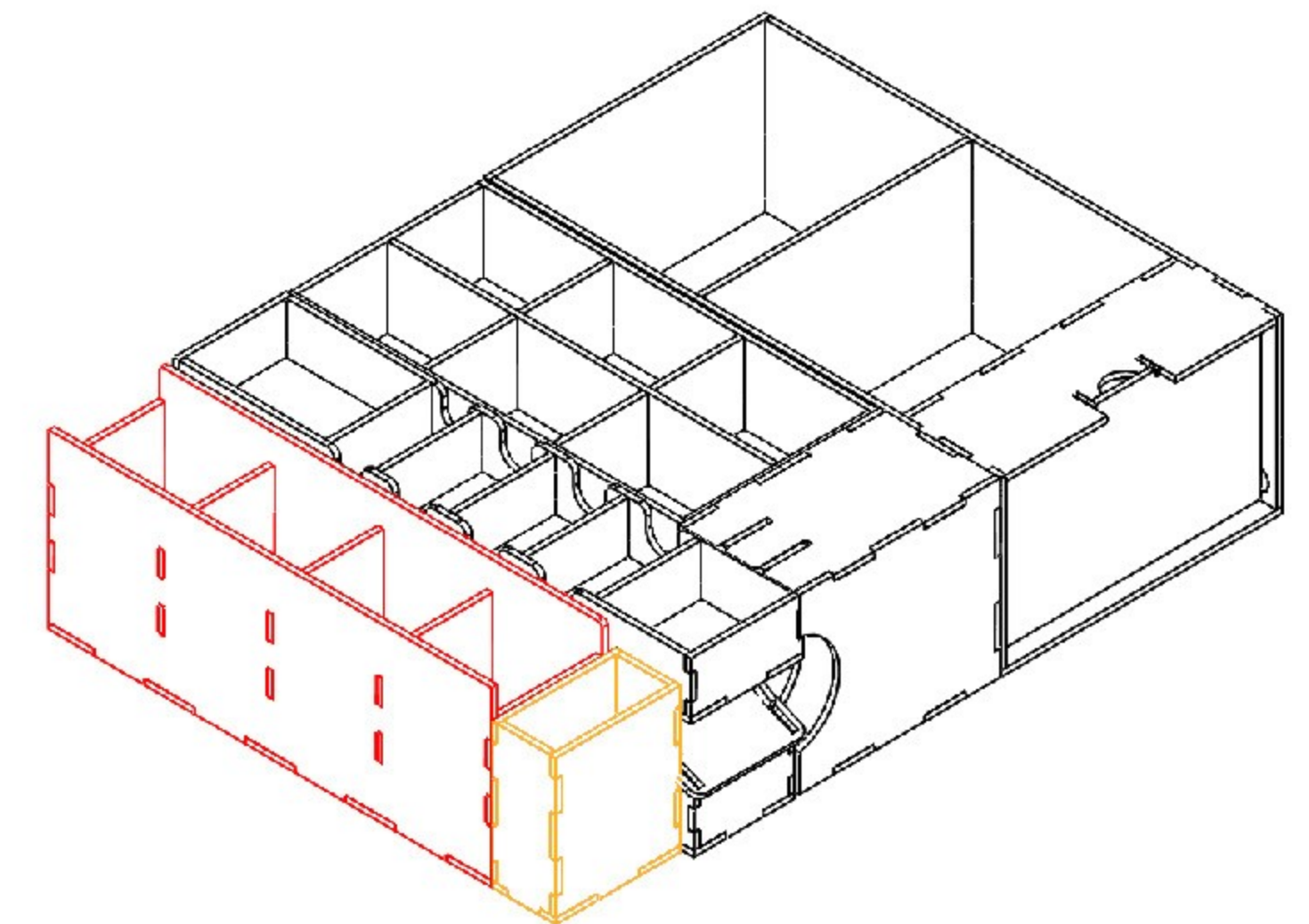
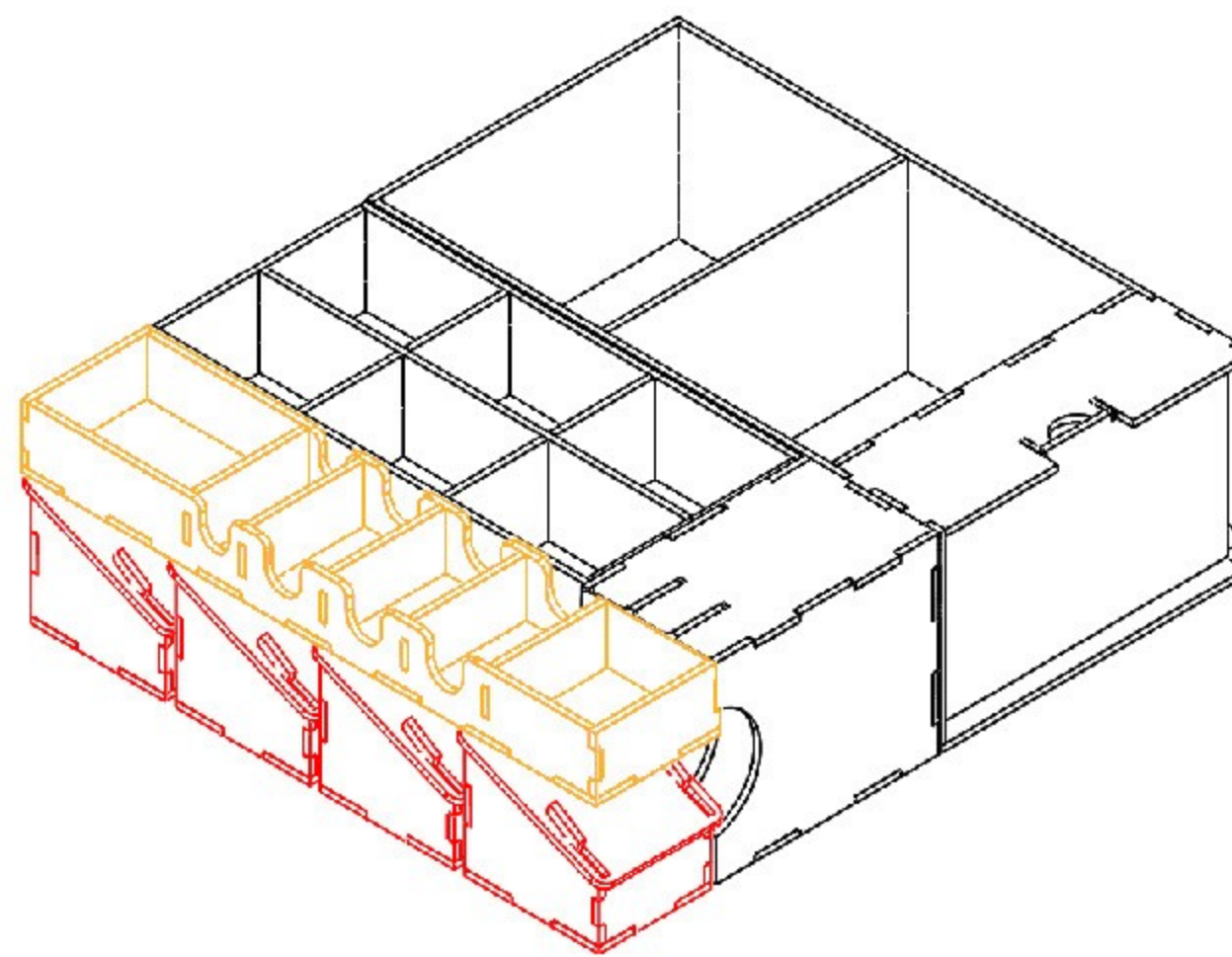
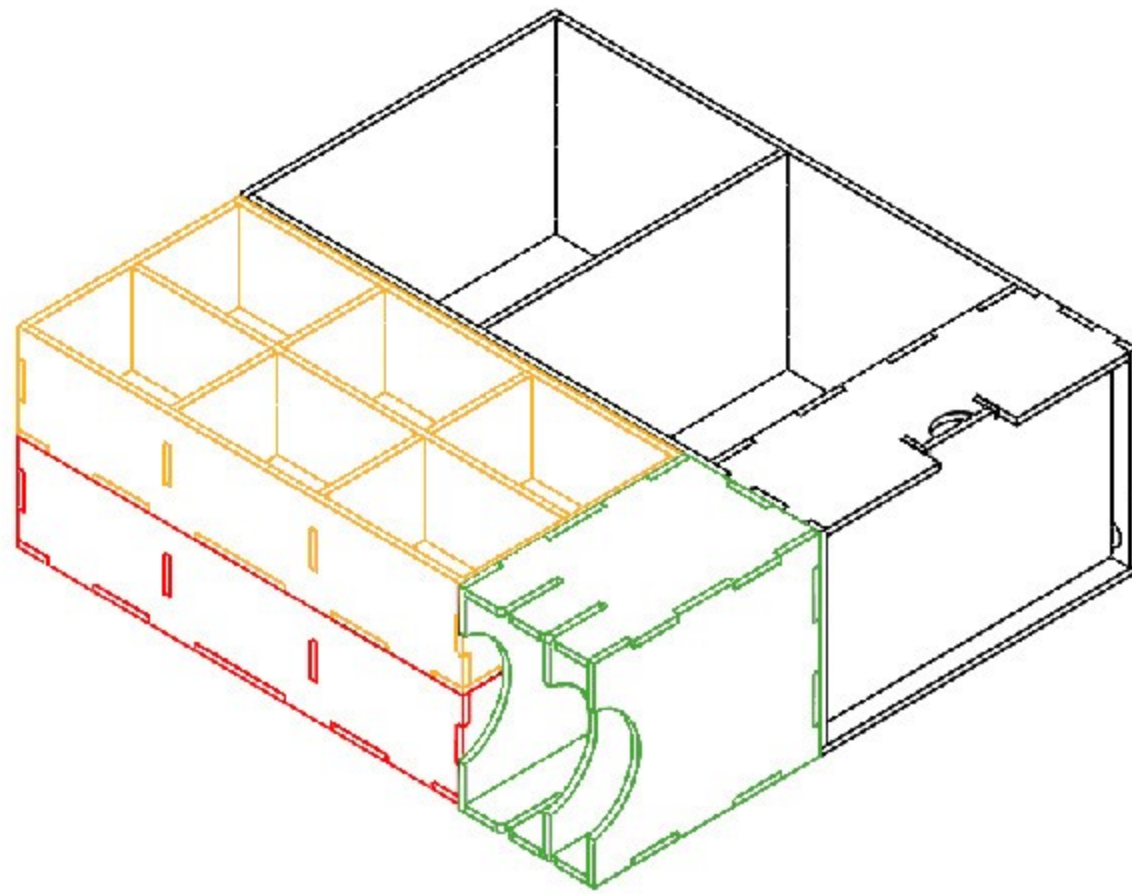

# LASEROX



Laserox Design Ltd.  
H-2092 Budakeszi  
Tiefenweg way 39

